

PRO

250 V2

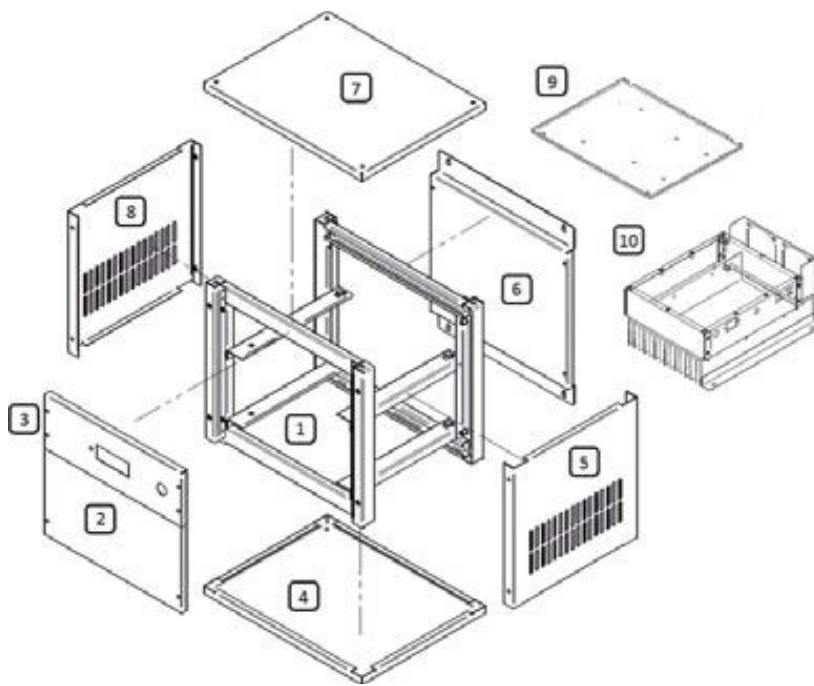

GRÁFICO
GRAPHIC

	Referencia / Reference	Descripción / Description	Observaciones / Notes
1	RACK-PRO200G-A	Estructura / Structure RACK-PRO200G	✓
2	RACK-PRO200G-B	Tapa frontal / Frontal cover RACK-PRO200G	✓
3	FRONTAL-PRO	Frontal equipos / Front part PRO250/500/750/1000	✓
3a	RACK-PRO200G-C	Tapa pantalla / Screen cover RACK-PRO200G	✓
4	RACK-PRO200G-D	Tapa superior / Up cover RACK-PRO200G	✓
5	RACK-PRO200G-E	Tapa trasera / Back cover RACK-PRO200G	✓
6	RACK-PRO200G-F	Tapa lateral izquierda (Conexiones) / Left side cover (Connections)	✓
7	RACK-PRO200G-G	Tapa lateral derecha / Right side cover	✓
8	RACK-PRO200G-H	Tapa lateral inferior / Row cover RACK-PRO200G	✓
9	PCPRO	Cuadro maniobra / Control Unit PRO250/500/750/1000	✓
9a	BAND-RACKSCH1000G	Bandeja soporte P954D armario PRO galvanizado / Support P954D in PRO Boxes	✓
10	FC250G	Módulo fuente conmutada / Power board SCH250	✓